

NOTE:
MODIFICATIONS TO THIS SPACE TO ALLOW THE PROPER FIT & FUNCTION OF THE EQUIPMENT SUPPLIED BY PATTERSON DENTAL SHALL BE THE RESPONSIBILITY OF THE OWNER/TECHNICIAN/ARCHITECT/CONTRACTOR IN REGARDS TO CODE COMPLIANCE OF STRUCTURAL, ELECTRICAL, MECHANICAL, AND PLUMBING ISSUES. THIS INCLUDES, BUT IS NOT LIMITED TO, SUPPORT STRUCTURE FOR EQUIPMENT AND CLEARANCES IN REGARD TO SPRINKLER HEADS AND/OR ANY DEVICE OR STRUCTURE WHICH MAY IMPEDE OR CONFLICT WITH THE FUNCTION OF PATTERSON SUPPLIED EQUIPMENT. PATTERSON DENTAL SHALL NOT BEAR ANY COST TO CORRECT THESE ISSUES. PLEASE CONSULT PATTERSON FOR ASSISTANCE IN EQUIPMENT SUPPORT STRUCTURE & THESE DRAWINGS AND SPECIFICATIONS ARE THE PROPERTY OF PATTERSON DENTAL SUPPLY AND THE USE LIMITED TO A SPECIFIC PROJECT FOR THE PERSON OR PERSONS NAMED HEREON FOR THE CONSTRUCTION OF ONE BUILDING ONLY. ANY USE OR REPRODUCTIONS OF THESE DRAWINGS ARE STRICTLY PROHIBITED WITHOUT THE WRITTEN PERMISSION OF PATTERSON DENTAL SUPPLY, INC.

WRITTEN DIMENSIONS SHALL TAKE PREFERENCE OVER SCALE DIMENSIONS AND SHALL BE VERIFIED ON THE JOB SITE.
ANY DISCREPANCIES OR CHANGES SHALL BE BROUGHT TO THE ATTENTION OF PATTERSON DENTAL SUPPLY PRIOR TO THE COMMENCEMENT OF ANY WORK.

THE CONTRACTOR SHALL BE RESPONSIBLE FOR ALL CURRENT AMERICAN DISABILITIES ACT, ADA, ACCESSIBILITY GUIDELINES.
THE CONTRACTOR SHALL ALSO BE RESPONSIBLE FOR ALL REQUIRED BACKFLOW PREVENTERS.
THE CONTRACTOR SHALL COMPLY WITH ALL STATE, CITY AND LOCAL CODES, PERTAINING TO THE CONSTRUCTION OF THIS PROJECT.

THESE DRAWINGS ARE FOR CONCEPT PURPOSES ONLY. THESE DRAWINGS ARE NOT TO BE USED FOR CONSTRUCTION AND DO NOT TAKE THE PLACE OF CONSTRUCTION PLANS AND SPECIFICATIONS. THESE DRAWINGS ARE NOT TO SCALE, NOR HAVE FIELD CONDITIONS BEEN VERIFIED. PATTERSON WILL NOT BE HELD RESPONSIBLE FOR THE USE OR MISUSE OF THE INFORMATION CONTAINED IN THESE DRAWINGS.

OWNER:
MISSION OF MERCY

LOCATION:
**BISMARK EVENT CENTER
BISMARK, ND**

DRAWN BY:
KRISTI DEMMEGAHL

EQUIPMENT REP:
PATTERSON DENTAL

EQUIPMENT REP #:
10246

ISSUE DATE:
07/27/2018

REVISIONS			
REV #	SCOPE	DRAWN BY	DATE
1	Revision 1	KAD	08/03/2018
2	Revision 2	KAD	08/07/2018
3	Revision 3	KAD	08/07/2018
4	Revision 4	KAD	08/20/2018
5	Revision 5	KAD	08/21/2018
6	Revision 6	KAD	09/19/2018
7	Revision 7	TK	02/19/2020
8	Revision 8	TK	03/10/2020
9	Revision 9	TK	04/16/2024
10	Revision 10	TK	05/31/2024

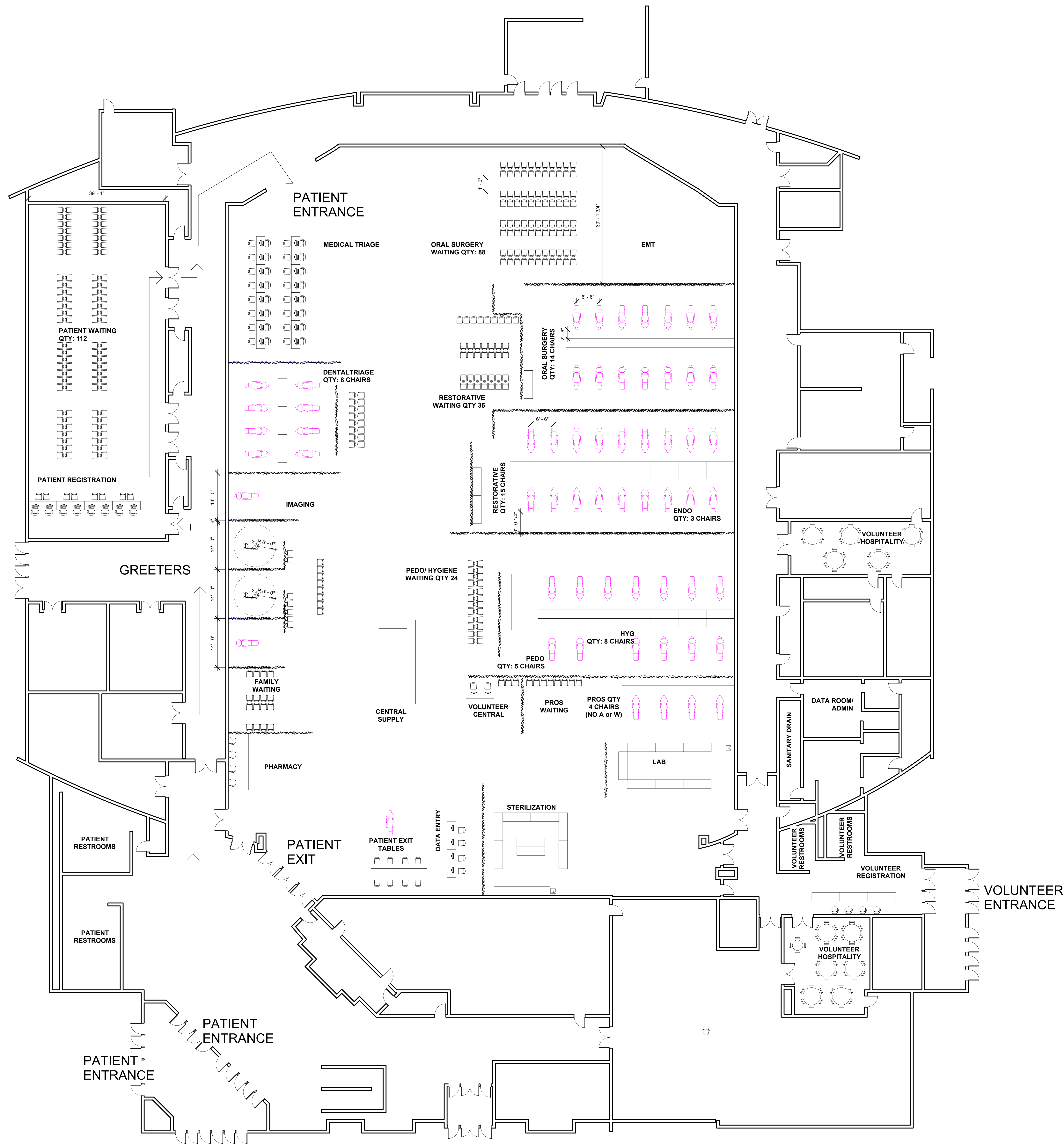

PLAN SYMBOLS

- DENTAL FURNITURE & EQUIPMENT
- DENTAL FURNITURE & EQUIPMENT EXISTING RELOCATED
- DENTAL FURNITURE & EQUIPMENT FUTURE
- EQUIPMENT NUMBER TAG NUMBERS ARE RANDOM

1 LVL 1 FLOOR PLAN
3/32" = 1'-0"

SHEET NO.
DA111